



POCKET GENTLEMAN DOOR KIT INSTALLATION NOTES

SAFETY

- PROPERLY ADJUSTED, THIS OPENER WILL OPERATE YOUR DOOR SAFELY. A CLOSING DOOR SHOULD BE EASY TO STOP WITH YOUR FINGER. EXCESSIVE OPENING SPEED OR POWER WILL DAMAGE THE "GENTLEMAN" AND THE DOOR COMPONENTS. THESE ADJUSTMENTS CANNOT BE MADE AT THE FACTORY AND ARE YOUR RESPONSIBILITY.
- PLEASE REMOVE BOTH SHIPPING RUBBER BANDS BEFORE INSTALLATION!!
- Do not kink or crush tubing during installation.
- The air tubing connections and control units are color coded with plastic zip ties.
- The cylinder should be mounted over the opening for access. If you choose to mount the cylinder back inside the wall, reverse the airlines to the cylinder at the control box. Call us for help if needed.
- The door must remain open for at least 5-10 seconds to charge up before it will re-close.
- See Figure 1 below for tubing and fitting connections.

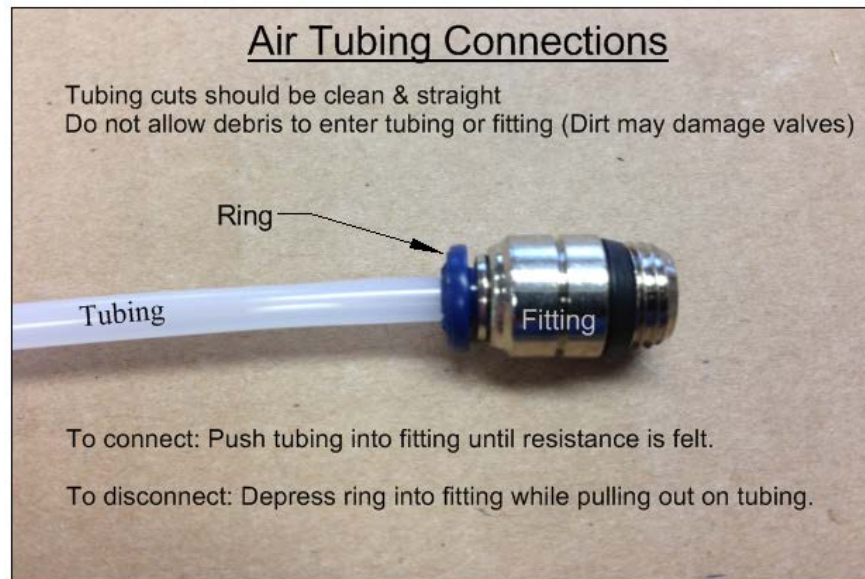

Figure 1

GENERAL INFORMATION

This opener is pneumatic and requires an air compressor (not included) that will sustain 80-100 PSI of air pressure. Multiple openers can operate from a single compressor. If there is an existing system, it may be used if it meets the above criteria.

A small and quiet air compressor located in a remote location is desired. (Basement or Garage) We can recommend a unit based on your installation, please contact GDA if you need assistance.

The Pocket Gentleman is comprised of many precision pneumatic controls and requires a clean source of air with minimal moisture. Draining the air compressor tank periodically is essential to eliminate moisture in the air.

OUTLET - Plug in 825LM Liftmaster Receiver then plug in transformer into receiver. Program Liftmaster 971LM Remote to receiver using instructions provided. (Standard Kit)

CYLINDER POSITION - It is recommended to mount the operator with the cylinder over the opening for easy access. (Use trim screws for access trim.) If desired, the cylinder can be mounted inside pocket. (Access panel recommended.) Questions? Call 800-525-7078.

POCKET DOOR BASIC LAYOUT

CONTROL BOX - Install 4' from an outlet and within 10' of door operator. You may need to install a new outlet to meet the location requirements. Two air lines (& optional wiring) will run from the operator to the control box, match the plastic wire tie colors on each air tube fitting.

AIR COMPRESSOR - Install 6' from an outlet and within 100' of control box. Locate in basement, utility room, or garage to minimize noise when running. One air line will run from the air compressor to the regulator inside control box. Set to 90 PSI. (Air Compressor not included in Standard Kit)

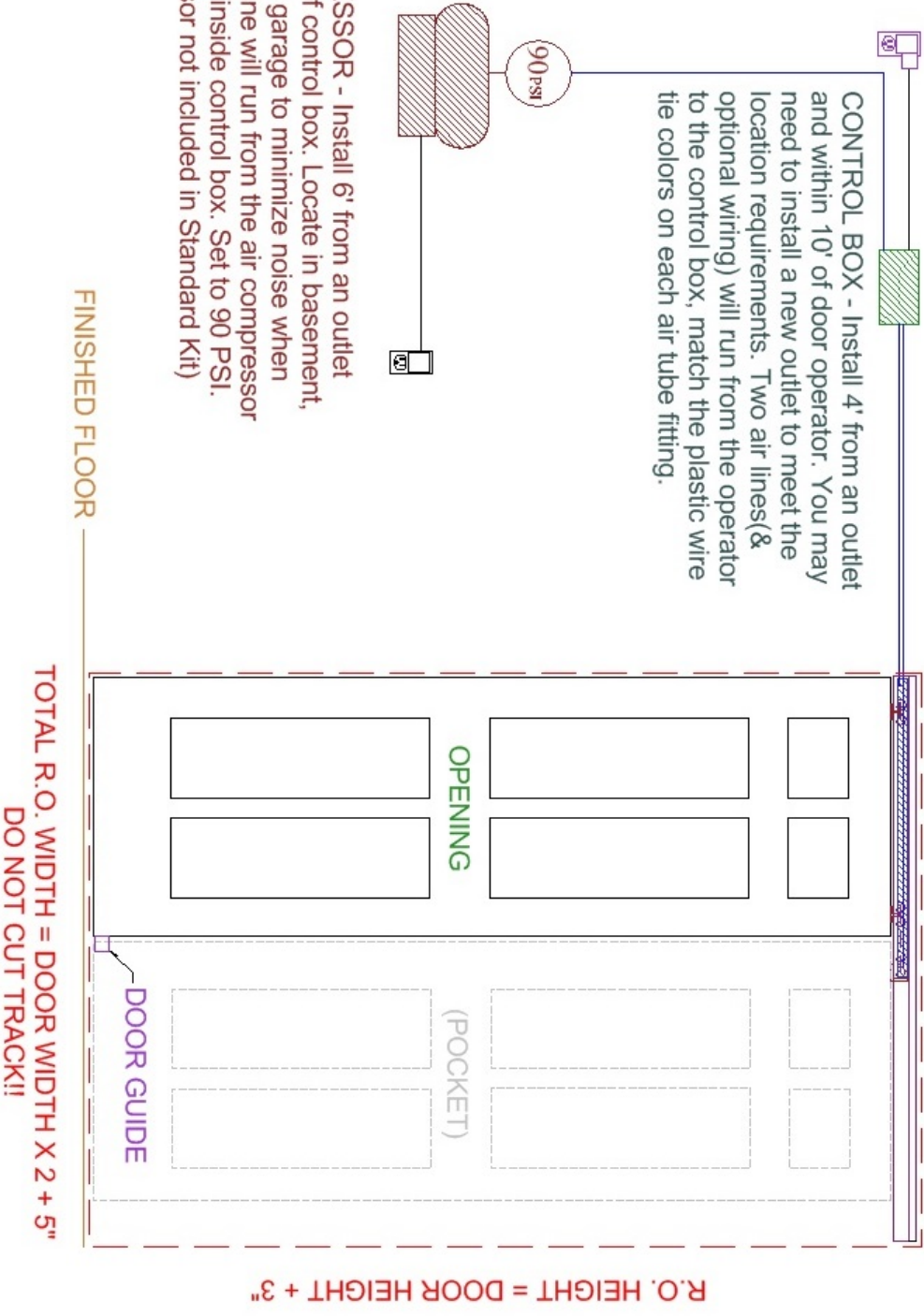

TOTAL R.O. WIDTH = DOOR WIDTH X 2 + 5\"
DO NOT CUT TRACK!!

Figure 2

ROUGH OPENING MEASUREMENTS - IMPORTANT!

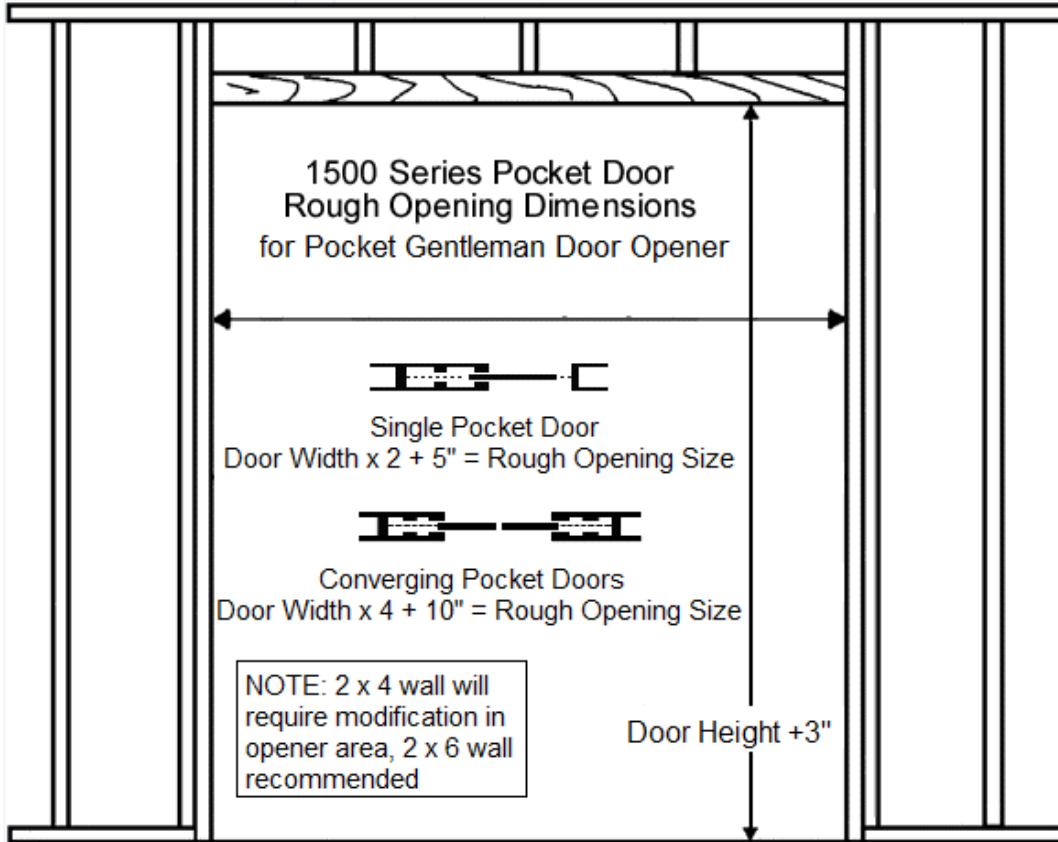

Example: 30" (Door size) x 2 = 60" + 5"(needed for opener) = 65" Rough Opening

HARDWARE PACK

Johnson Pocket Door Hardware included with *Pocket Gentleman* Door Opener



INSTALLATION

- Mount the pocket door hardware using the modified Johnson installation instructions below. Plan accordingly to allow room for the operator; the instructions are only a guideline.
- The cylinder and trolley must be free to move, do not apply any pressure to either with finished wall or trim panel. Please do not cut the track. A 2 x 6 wall is recommended when possible.



INSTRUCTIONS

For 1-3/8" to 1-3/4" Doors weighing up to 200 lbs.
NOTE: The lead roller on the front trolley does not support door.

100PD SERIES HARDWARE FOR "JOB-SITE" POCKET DOORS

www.johnsonhardware.com

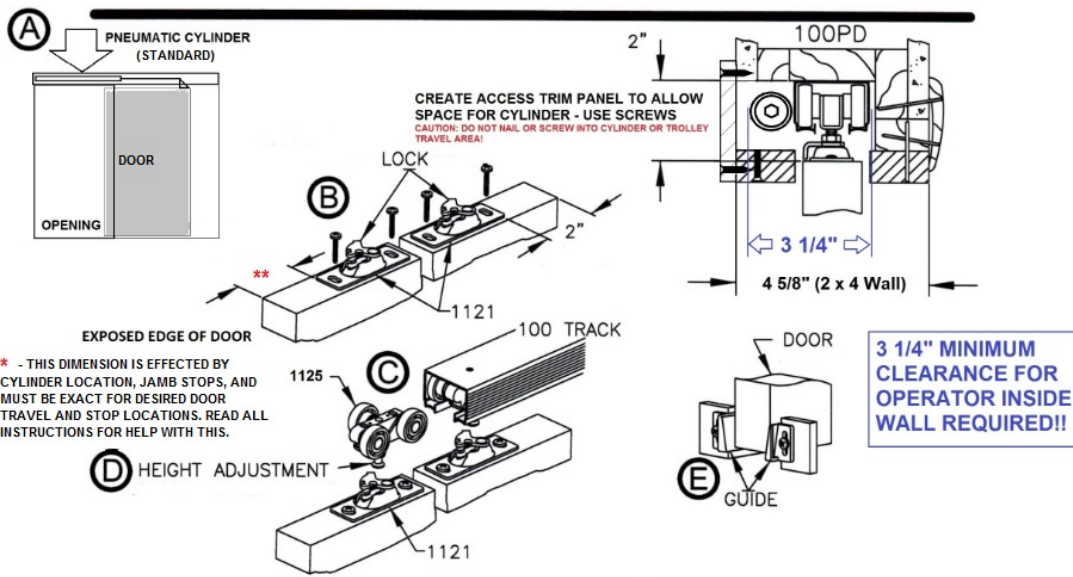

** - THIS DIMENSION IS EFFECTED BY CYLINDER LOCATION, JAMB STOPS, AND MUST BE EXACT FOR DESIRED DOOR TRAVEL AND STOP LOCATIONS. READ ALL INSTRUCTIONS FOR HELP WITH THIS.

NOTE: Track must be level and square with jamb. Door must be sealed on all 6 sides.
A/Mount Track with cylinder over opening for easy access after installation. This step is optional.
B/Attach Door Plates (1121) on top of the door with lock tabs on same side.
C/Mount Door by locating door plate (1121) under adjusting bolt of Hanger (1125) and tilting door until bolt will slide into seat of Door Plate (1121). Repeat with other Hanger/Door Plate.
D/Adjust Hangers (1125) for height and plumb with jamb. NOTE: Front hanger threads factory coated with a mild locktite.
E/Attach Guides (1550) at bottom of opening and adjust so door is centered in opening.

IN100SLD L.E. JOHNSON PRODUCTS, INC. - 2100 STERLING AVE. - ELKHART, IN USA 46516 - (574) 293-5664 Rev. 05/09
 INSTRUCTIONS MODIFIED FOR GENTLEMAN DOOR AUTOMATIC POCKET DOOR KIT APPLIED TO JOHNSON HARDWARE. 800-525-7078

**

HELPFUL HINT: Use a 1" scrap piece of wood (cut to your door's width & thickness) to determine where to mount the trolley Door Plate. Move the scrap piece by hand through its entire range. You must account for jamb stops and space between converging doors in this manner. Make adjustments by moving the Door Plate at the trolley only. When you are satisfied with the positioning, transfer the locations of the Door Plates to the door.

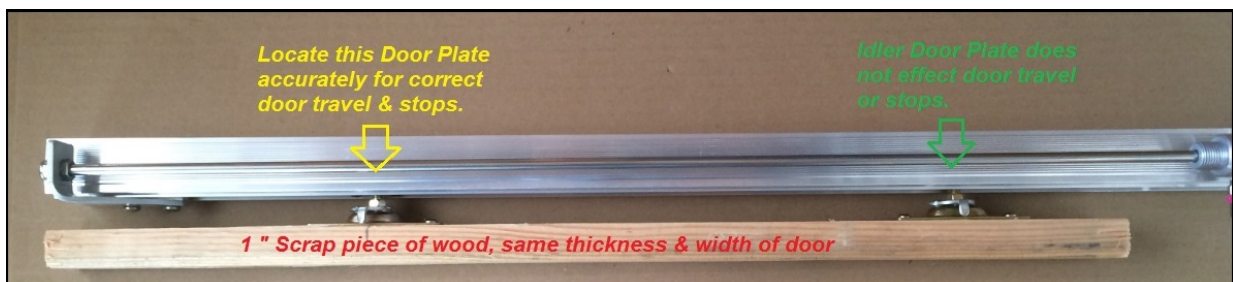

SAFETY-READ CAREFULLY

The whole purpose of the adjustment procedure is to adjust the amount of force required to cause the closing pressure to cease if an object is encountered in a closing door. Properly adjusted, if it closes on your hand it should not hurt. Do not, however, test in this manner. Rather, use a soft inanimate object.

CAUTION: IF THE DOOR WILL NOT SUBMIT TO AN OBSTRUCTION WHILE CLOSING, THE PNEUMATIC OBSTACLE DETECTION AND DEACTIVATION IS NOT WORKING PROPERLY. YOU WILL NEED TO REVERSE THE AIRLINE CONNECTIONS AT THE CONTROL BOX GOING TO THE CYLINDER!

NOTE: THE UNIT IS ADJUSTED AT THE FACTORY, PLEASE MAKE CONNECTIONS AND CYCLE THE UNIT SEVERAL TIMES BEFORE MAKING FURTHER ADJUSTMENTS.

1. Make sure remote control or switching system you are using is operational and the **Regulator (Figure 3)** has 90-100 PSI air supply coming into it. (Figure 2)
2. Activate control box to open the door or you may depress the manual activation button on the top of the solenoid to simulate the solenoid being energized.
3. At the **Regulator** inside control box, increase pressure (turn clockwise) to the point where door will just open. (Minimum point) Further Increase pressure at **Regulator** approximately one additional turn.
4. Deactivate solenoid valve to close door and observe operation.
 - A. If door closes all the way:

Open vent on **Flow Control Bleed Valve (Figure 3)** (turn CCW) and repeat steps 2 and 5 waiting about 5 seconds between steps. Repeat this procedure until door will not fully close (i.e. stops) before reaching fully closed position.
 - B. If or when door closes part way and stops:

Close vent on **Flow Control Bleed Valve** (turn clockwise) and repeat steps 2 and 5 waiting about 5 seconds between steps. Repeat this procedure as many times as necessary until door will fully close 100 % of the time.

Try to approach this point with very small incremental adjustments.
5. Observe closing speed.
 - A. If door closes too slowly (more than about 7 seconds), increase pressure at **Regulator** (Step 3) approximately 1/2 turn and repeat step 4.
 - B. If door closes too quickly (less than about 4 seconds), decrease pressure at **Regulator** approximately 1/2 turn and repeat step 4.
6. Open or close valve marked **Needle Valve (Figure 3)** to increase (CCW) or decrease (CW) opening speed only. Again, adjust to the 4 to 7 second range.

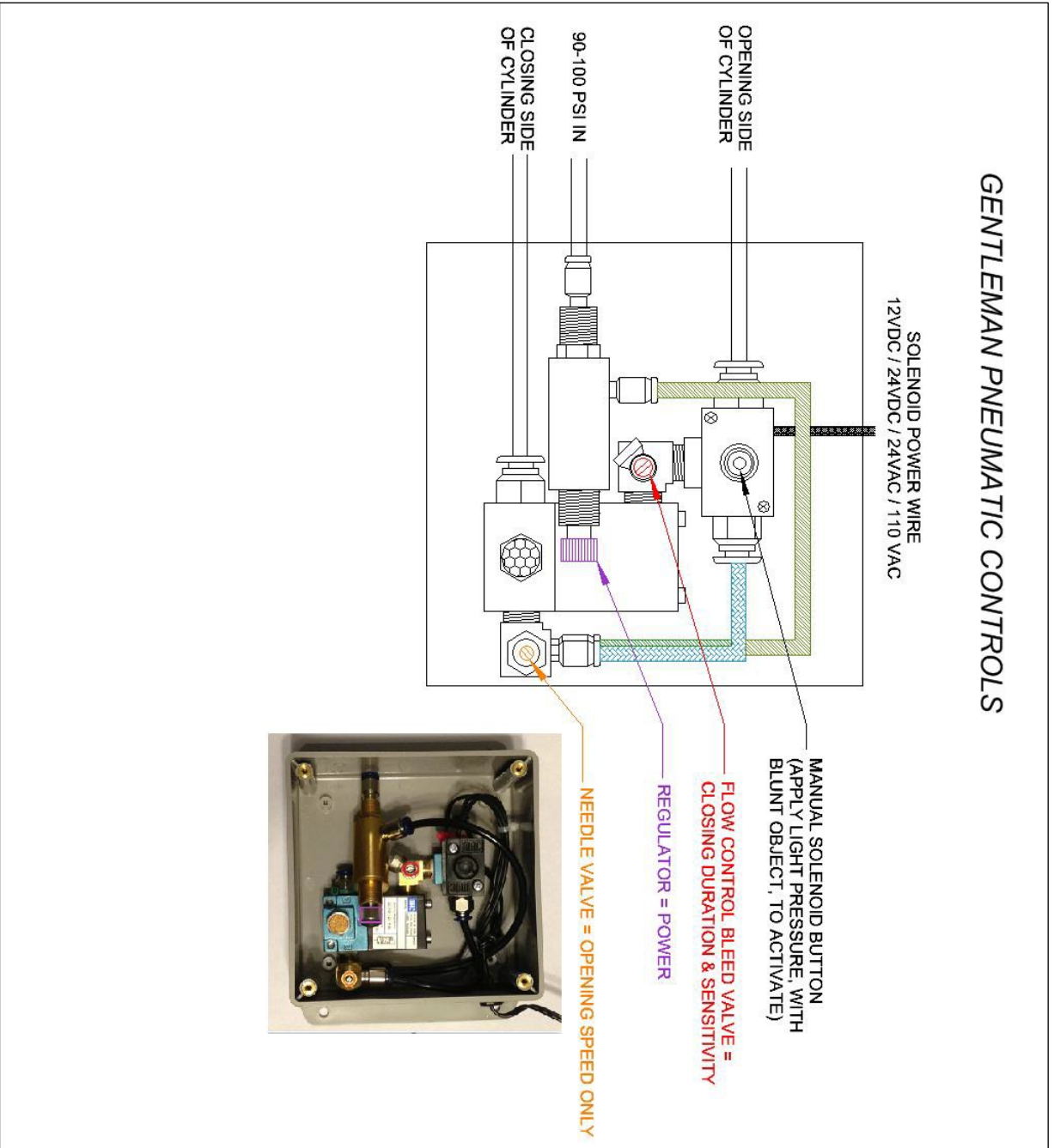

Figure 3

Thank you for choosing Gentleman Door Automation!